



CONSTRUCTION UPDATE – Broadway Reopened; Crews to Work on Restoring Curb and Cutter and Demolishing Old Pump Station [Update as of Friday, February 4, 2022](#)

Note: All work is weather permitting and subject to change without notice.

CONTACT for questions and concerns:

Patti Watson, 505-245-3134 office; 505-269-9691 cell; pattiw@cwstrategic.com

Broadway Blvd was reopened to traffic on Friday, Feb. 4; however, work will continue on this project through April 2022.

Beginning **Monday, February 7**, and lasting for about 14 days through **Monday, February 21**, the left-hand lanes on eastbound and/or westbound Lomas Blvd will be closed from Broadway Blvd to Edith Blvd so that crews can restore curb and gutter and medians that were removed earlier in the project.

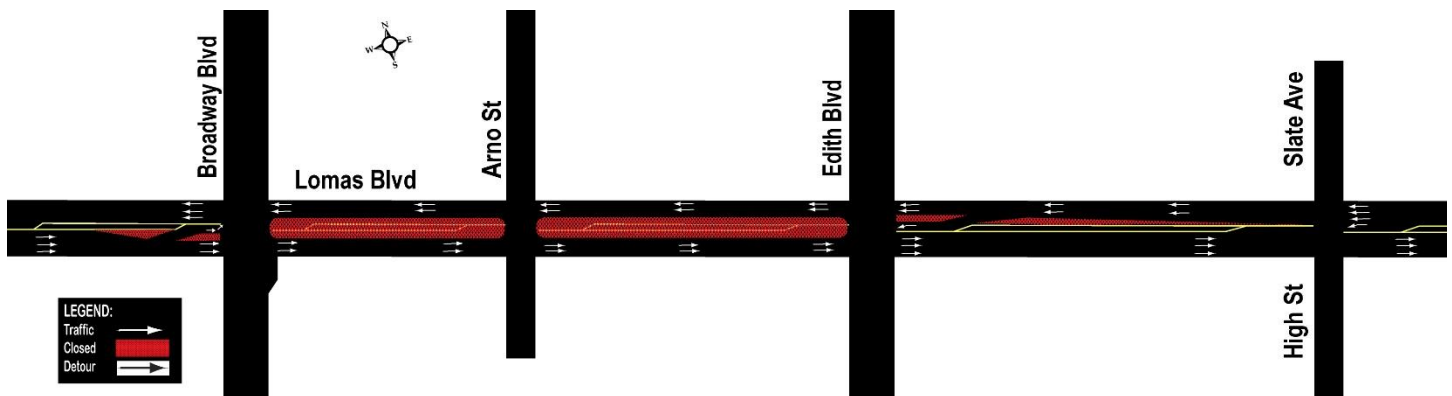

Also, beginning on **Monday, February 14**, the right-hand lane of southbound Broadway will be closed from **Granite Ave to Marble Ave** so that crews can demolish the old pump station. More details and a map will be provided for this closure next week.

We appreciate your patience as crews work to complete the project. Regular work hours are **Monday-Friday** from **7 a.m.-5 p.m.**, although the contractor may work longer hours or on weekends as needed. ***All construction is weather permitting and is subject to change without notice.***