

CONSTRUCTION UPDATE – Crews continuing work on Arno and Marble with plans to install median paving on Lomas Blvd. in Mid-March
[Update As of Monday, March 8, 2021](#)

CONTACTS for questions and concerns:

Patti Watson, 505-245-3134 office; 505-269-9691 cell; pattiw@cwastrategic.com

Lucas Baca, 505-417-9989 cell; lucasb@cwastrategic.com

ONGOING: Crews are continuing work on Arno. Arno is closed to thru traffic from north of Lomas Blvd. to south of Marble Ave. Also, Marble Avenue is closed to thru traffic from Arno Street to Broadway Blvd. *Local traffic only is allowed and access will be maintained to all businesses and residents.* Traffic can use Broadway Blvd. or Lomas Blvd. as detours. **Please use extra caution and avoid the area of the trench if at all possible.**

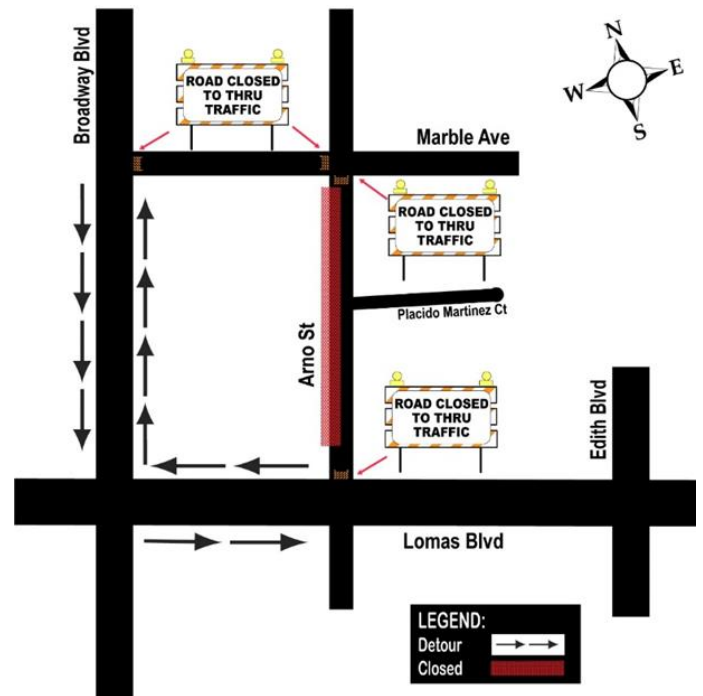
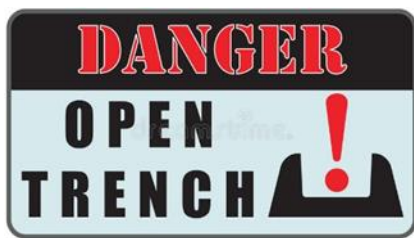

NEW: Beginning **Monday, March 15, 2021** and lasting through **Friday, March 19, 2021**, crews will install temporary median paving on Lomas Blvd. **During this work, the inside (left) lanes of eastbound and westbound Lomas Blvd. will be closed between Edith Blvd. and Broadway Blvd.** Two lanes of traffic will remain open in each direction. (See map below.)

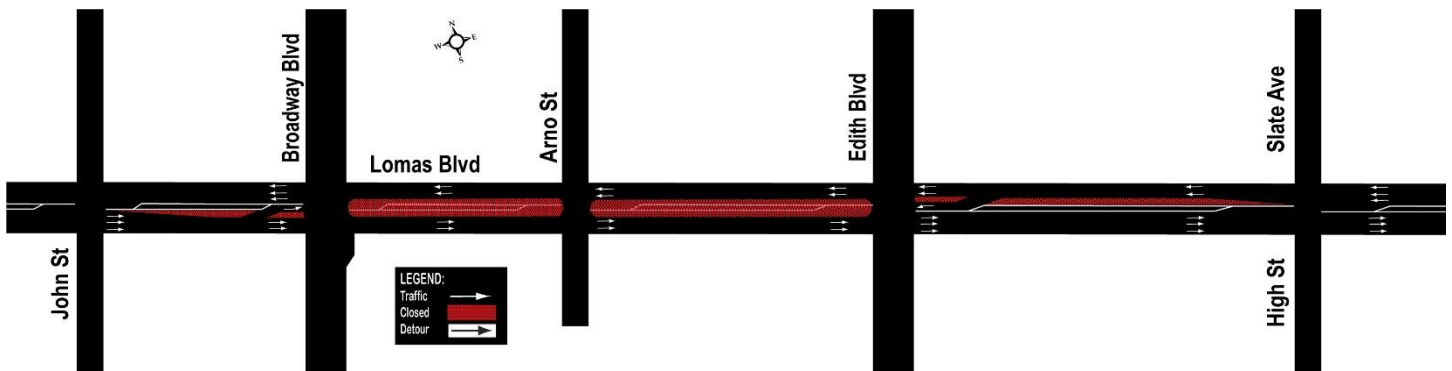

AUI is the contractor for the project. Regular work hours are **Monday-Friday from 7 a.m.-5 p.m.**, although the contractor may work longer hours or on weekends as needed.

For more information, please visit www.marblearno.com. You can also sign up for **free** construction updates via email. Contact **Lucas Baca** or **Patti Watson** at the numbers and email addresses above with your questions or comments. **All construction is weather permitting and is subject to change without notice.**