

**CONSTRUCTION UPDATE – Crews continuing work on Arno and installing median paving on Lomas with plans to install storm drainage on Lomas beginning Friday, March 19**

[Update As of Monday, March 15, 2021](#)

**CONTACTS** for questions and concerns:

**Patti Watson, 505-245-3134 office; 505-269-9691 cell;**

[pattiw@cwastrategic.com](mailto:pattiw@cwastrategic.com)

**Lucas Baca, 505-417-9989 cell; [lucasb@cwastrategic.com](mailto:lucasb@cwastrategic.com)**

**ONGOING:** Crews are continuing work on Arno. Arno is closed to thru traffic from north of Lomas Blvd. to south of Marble Ave. Also, Marble Avenue is closed to thru traffic from Arno Street to Broadway Blvd. *Local traffic only is allowed and access will be maintained to all businesses and residents.* Traffic can use Broadway Blvd. or Lomas Blvd. as detours. **Please use extra caution and avoid the area of the trench if at all possible.**

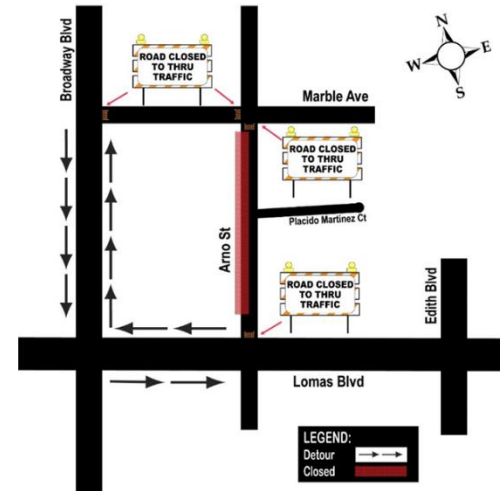

Lasting through **Friday, March 19, 2021**, crews will install temporary median paving on Lomas Blvd. During this work, the inside (left) lanes of eastbound and westbound Lomas Blvd. will be closed between Edith Blvd. and Broadway Blvd. Two lanes of traffic will remain open in each direction. (See map below.)

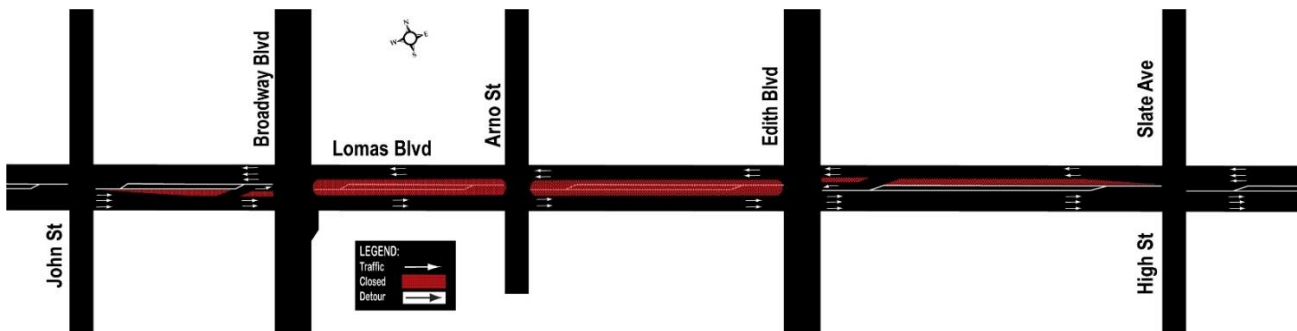

**NEW:** Beginning **Friday, March 19, 2021** and lasting about three weeks, through **Friday, April 9, 2021**, crews will install storm drainage pipe on Lomas Blvd. The north side of Lomas will be closed from Edith Blvd. to west of Arno Street. Traffic will be shifted to the south side of Lomas in this area, with one lane of traffic open westbound and two lanes of traffic open eastbound. (See map below.) **Access will be maintained to all residences and businesses.**

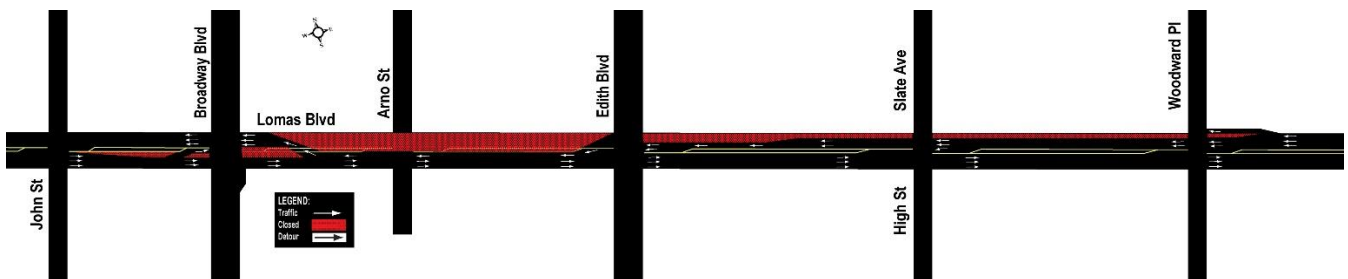

AUI is the contractor for the project. Regular work hours are **Monday-Friday from 7 a.m.-5 p.m.**, although the contractor may work longer hours or on weekends as needed. **All construction is weather permitting and is subject to change without notice.**