

CONSTRUCTION UPDATE – Work continuing on Broadway and on Arno Street between Lomas Blvd. and Marble Ave.

[Update As of Friday, Jan. 15, 2021](#)

CONTACTS for questions and concerns:

Patti Watson, 505-245-3134 office; 505-269-9691 cell; pattiw@cwstrategic.com

Lucas Baca, 505-417-9989 cell; lucasb@cwstrategic.com

CONTINUING: Kelly Cable is continuing to work in Broadway for Century Link. We do not have an estimated completion time for this work as of this update. **Broadway has both the northbound and southbound outside lanes closed north of Lomas Blvd. as well as a small portion of northbound Broadway closed south of Lomas Ave.** Access will be maintained to the Carl's Jr. and the Starbucks Coffee.

ONGOING: Lasting through late February or early March 2021, Arno Street is closed to thru traffic from north of Lomas Blvd. to south of Marble Ave. Also, Marble Avenue is closed to thru traffic from Arno Street to Broadway Blvd. *Local traffic only is allowed and access will be maintained to all businesses and residents.* Traffic can use Broadway Blvd. or Lomas Blvd. as detours.

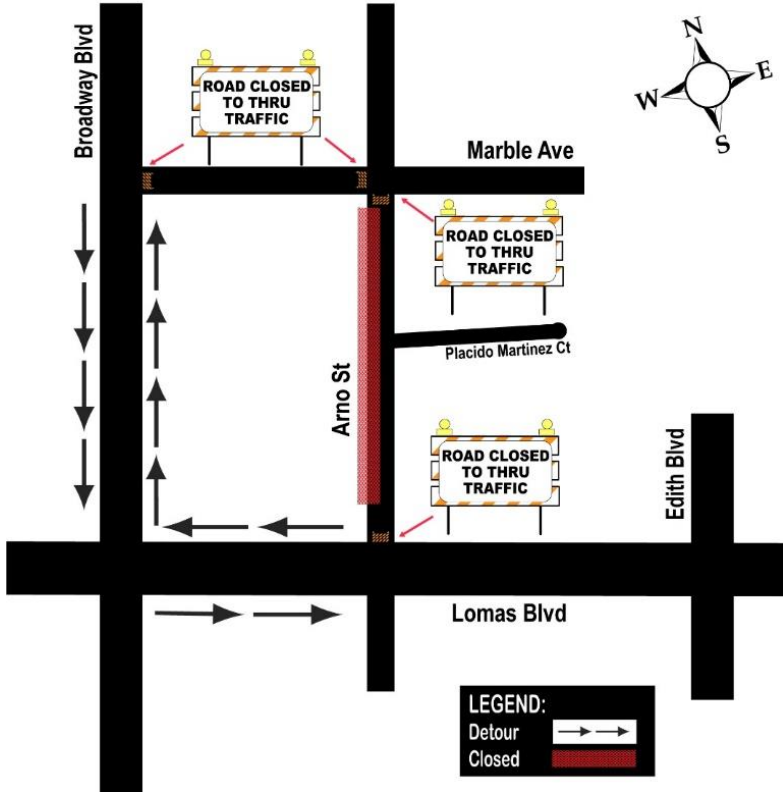
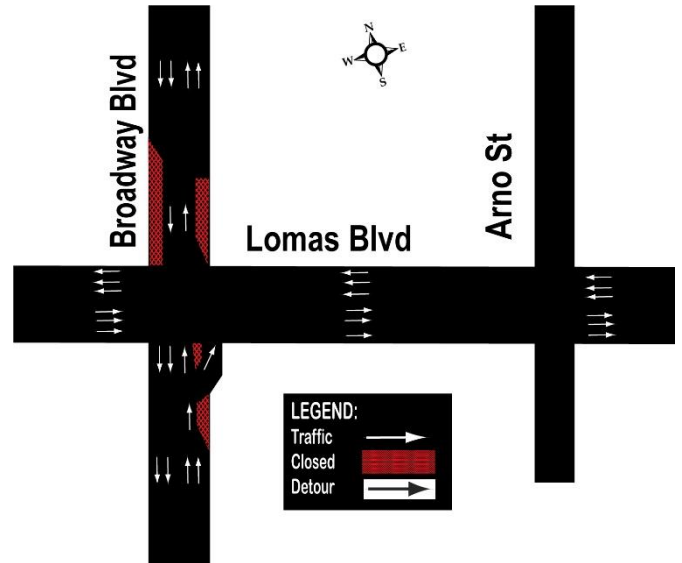

Crews are installing new storm drainage pipeline, which requires a deep



trench. **Please use extra caution and avoid the area of the trench if at all possible.**

AUI is the contractor for the project.

Regular work hours are **Monday-Friday from 7 a.m.-5 p.m.**, although the contractor may work longer hours or on weekends as needed.

For more information, please visit www.marblearno.com. You can also sign up for **free** construction updates via email. Contact **Lucas Baca** or **Patti Watson** at the numbers

and email addresses above with your questions or comments.

All construction is weather permitting and is subject to change without notice.